



Modular Steel Bridge Delta Bridge Permanent Long Span Heavy Load BS5400 HA+20HB 4.2m Width

Our Product Introduction

Basic Information

- Place of Origin: China
- Brand Name: Tongkai
- Certification: ISO, EN1090, SGS, CIDB
- Model Number: TKD450
- Minimum Order Quantity: 1 set
- Price: 1500USD ~2000USD/ton
- Packaging Details: Nude and Steel case
- Delivery Time: 45days
- Payment Terms: L/C, T/T, Western Union, MoneyGram
- Supply Ability: 3000/month



Product Specification

- Model: TKD450
- Span: Upto 90m
- Material: S4200, 460J0, S355JR, S355J0, Gr65, Gr50
- Load: HA, HB, HA+20HB AASHTO HL-93, HS35-44
- Lane: Single Lane 3.15m~4.2m Double Lane 7.35m, three Lane 10.5m Three Lane:10.5m
- Surface Finish: Painted Or Galvanized
- Highlight: **Modular Steel Bridge BS5400,
Modular Steel Bridge Heavy Load,
Modular Steel Bridge Permanent**



More Images



for more products please visit us on tkbridges.com

Product Description

Modular Steel Bridge Delta Bridge Permanent Long Span Heavy Load BS5400 HA+20HB 4.2m Width

PRODUCT DESCRIPTION

TKD450 Bridge, also known as Delta Steel Bridge, is a kind of half-through permanent compact panel bridge, with the single span length from 36m to 90 m; the carriage way width is 4.2m for single lane and 7.35m for double lane; the bridge deck can adopt concrete and steel deck.

The bridge uses standardized, interchangeable steel components with full highway loading capability to provide a permanent, steel bridging solution which can be configured for clear spans of up to 90 meters. It can also be supplied in multiple spans, supported on intermediate piers, meaning that there is no limitation to the length it can bridge.

It is precision-engineered and therefore quickly and easily installed, with minimal construction equipment. This offers significant advantages over more traditional solutions, such as concrete bridges, which require skilled labour and heavy-duty equipment, and necessitate long lead-times together with major on-site construction work.

The benefits offered by the Delta" therefore ensure quick, safe and efficient project delivery, reduce project risk, and deliver substantial savings, making it the preferred long-span solution of choice for customers all over the world.

The top chord and the bottom chord of the main girder are modularized unit with H-shape section; The web member system is also modularized unit with K-shape.

All components of the bridge shall be of brand new manufacture by a fabricator accredited with ISO 9001 and EN 729, or equivalent international quality guarantee qualifications.

APPLICATION

Permanent or semi-permanent bridging
Long span bridging
Rural infrastructure project
Urban traffic project
Humanitarian aid and disaster relief operation
Construction site access
Replacement of damaged bridge

Technical Specification

Span	36m upto 90m
Road Width	single lane 4.2m ; double lane 7.35m, three lane:10.5m
Material Grade	S420J0,S355JR,GR65,GR50
Load Capacity	HL-93,HS25-44, HA ,HA+20HB
Surface Finish	Painted or Galvanized
Joint System	Bolt System
Erection Method	Crane lifting , Cantilever Launching Method

Key features of the system include

Clear spans up to 90m
4.5m module length
4.2m (extra wide), 7.35m (2 lane) or 10.5m (3 lane) carriageways
Optional 1m or 1.5m pedestrian walkways
Vehicle parapets as standard
Full highway load-carrying capability
Full-scale tested
Pre-cambered to remove dead load deflection
Proprietary steel decking system featuring pre-loaded/slip resistant bolts
Factory-applied anti-skid or site-applied asphalt-surfacing
Steel sub-grades suitable for cold climate applications (AASHTO Zone 3)
Seismically robust

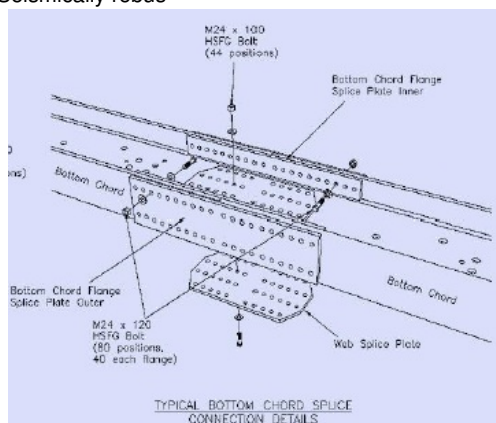



Zhenjiang Tongkai Mechanical Engineering Co.,Ltd.



008613813883197



andy@tkmachinery.com



tkbridges.com

Room 202, Jintai Building, Runxing Road, High tech Zone, Zhenjiang Jiangsu, China